

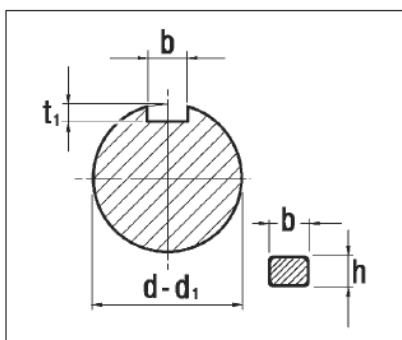

1.9 Шпонки



Входной вал

d_1	$b \times h$	t_1
16	5 x 5	3.0
19	6 x 6	3.5
24	8 x 7	4.0
28	8 x 7	4.0

Выходной вал

d	$b \times h$	t_1
11	4 x 4	2.5
14	5 x 5	3.0
16	5 x 5	3.0
19	6 x 6	3.5
20	6 x 6	3.5
24	8 x 7	4.0
25	8 x 7	4.0
28	8 x 7	4.0
30	8 x 7	4.0
35	10 x 8	5.0
38	10 x 8	5.0
40	12 x 8	5.0
48	14 x 9	5.5
50	14 x 9	5.5
60	18 x 11	7.0